

# 900mm 2 Drawer Base Unit + 1 Internal

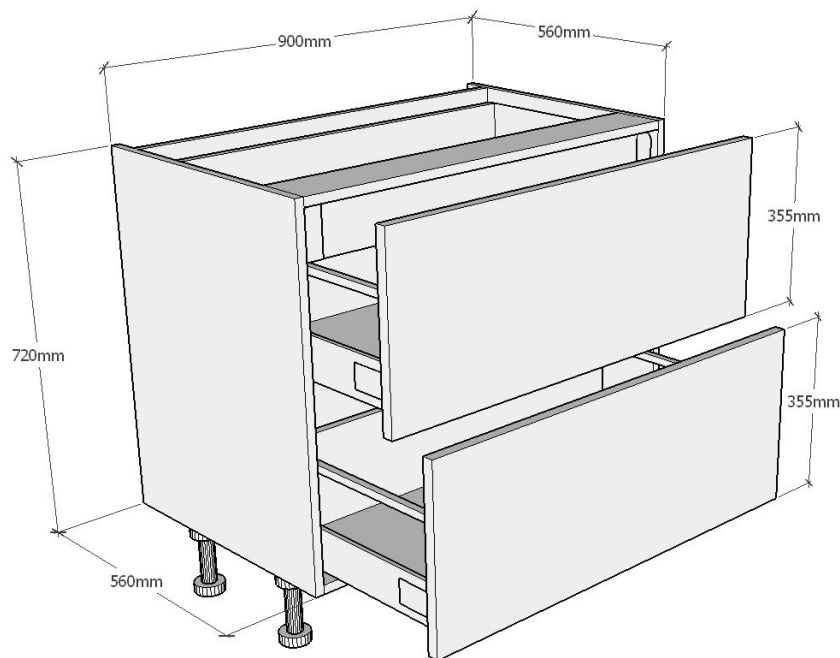

## Information

Standard 2 drawer base unit supplied with two 355 x 896mm drawer fronts and an Internal drawer. Legs and soft close drawer fittings included.

## Cabinet Specification

18mm thick colour matched cabinet (where possible).

47mm Service Void.

150mm Plastic Legs (adjustable from 140-160mm).

Soft Close Drawer Fittings.

Soft Close Internal Drawer.

## Fitting Instructions

Insert the 150mm Leg piece (found in plastic fittings bag supplied) into each of the sockets on the base of the cabinet. Level the unit as required and securely fix any adjacent units using the Cabinet Connectors and to the wall using the supplied 'L' Brackets and appropriate screws (not supplied).

## Special Notes

This unit is supplied with an Internal drawer fitted behind the top drawer front. The Pan Drawer below has a reduced mechanism height of 160mm to allow for the Internal Drawer fitting.

If this unit is to be supplied flat pack, the drawer fittings will be supplied loose.