

# 600mm 3+1 Pan Drawer Base Unit

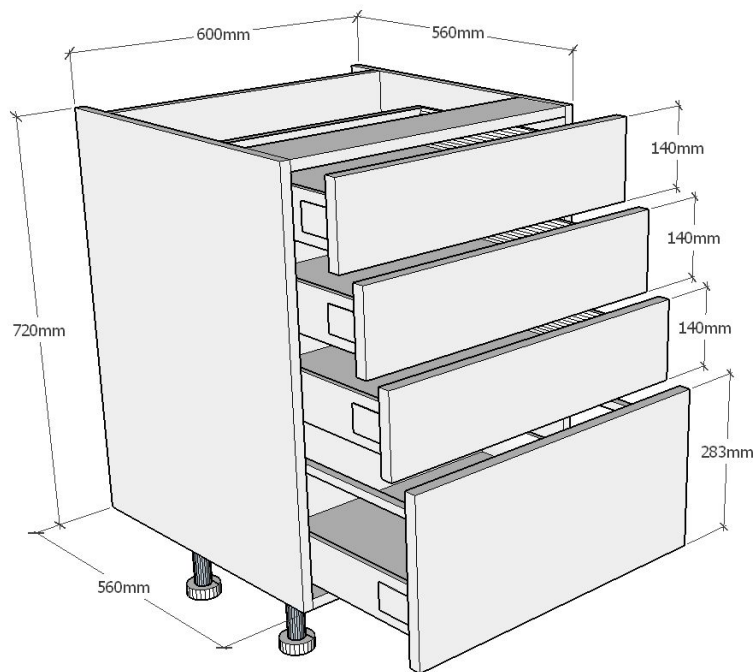

## Information

Four drawer base unit supplied with three 140 x 596mm and one 283 x 596mm drawer fronts. Legs and soft close drawer fittings included.

## Cabinet Specification

18mm thick colour matched cabinet (where possible).

47mm Service Void.

150mm Plastic Legs (adjustable from 140-160mm).

Soft Close drawer fittings.

## Fitting Instructions

Insert the 150mm Leg piece (found in plastic fittings bag supplied) into each of the sockets on the base of the cabinet. Level the unit as required and securely fix any adjacent units using the Cabinet Connectors and to the wall using the supplied 'L' Brackets and appropriate screws (not supplied).

## Special Notes

None